



FOR SALE

£270,000

5 Catisfield Road, Milton,
Southsea, PO4 8NH.

Tenure: Freehold

ESTATE  AGENTS

LAWSON ROSE

PROPERTY DESCRIPTION

This attractive three bedroom bay and forecourt property, located in the ever-popular residential area off Milton Road, could make for an ideal first-time purchase or family home. Positioned on Catisfield Road, the accommodation begins with a bright and spacious living room featuring a large bay window, followed by a generous second reception room currently arranged as a formal dining area, and a fitted kitchen to the rear. Beyond the kitchen is a useful lean-to / conservatory space providing access to a ground floor W.C. and the rear garden. The garden measures approximately 40ft, is mainly laid to lawn, and offers an excellent space for both relaxation and entertaining. The first floor comprises a fitted family bathroom suite and three well-proportioned double bedrooms, offering comfortable accommodation throughout. In our opinion, this is a fantastic opportunity within a sought-after location, and we strongly recommend an internal viewing to fully appreciate everything this home has to offer. For further information or to arrange a viewing, please contact the Lawson Rose sales office today.

Material Information:

- Construction: Brick Built
- Electricity Supply: Alternating Current
- Heating: Gas Central Heating
- Water Supply: Mains Water Supply
- Sewage: Mains Sewage
- Broadband: Standard, Superfast Fibre and Gfast Fibre are available.
- Mobile: Ofcom Checker shows EE, Three, O2 and Vodafone all have voice and data availability in this area.
- Council Tax: Portsmouth City Council – Band
- Flood Risk – Low Risk (Stated on the Gov.uk portal)



02392 367 779 - contactus@lawsonrose.com
131 Winter Road, Southsea, PO4 8DS





GROUND FLOOR

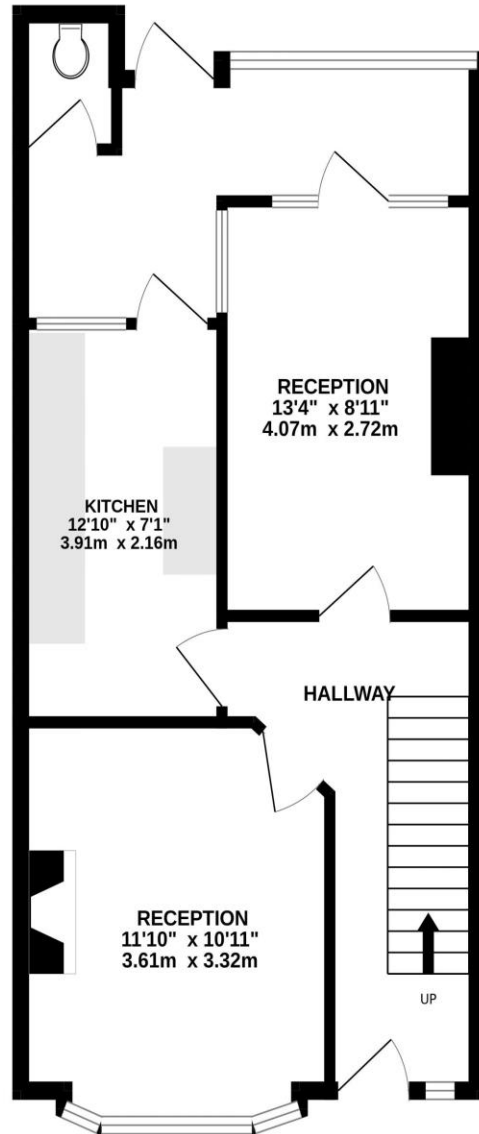

1ST FLOOR

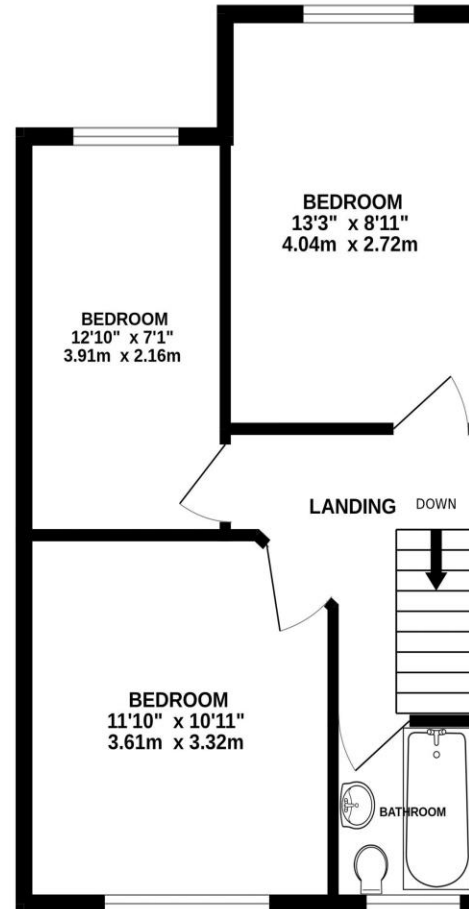

Please note that none of the services or appliances have been tested by Lawson Rose Estate Agents.